

G Union

EO 24° cone end

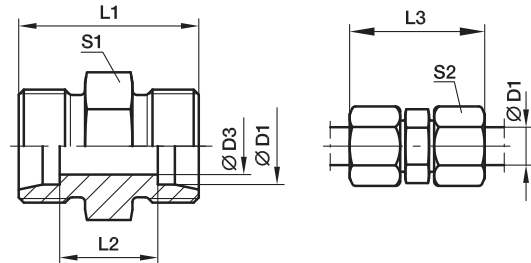

Series	D1	D3	L1	L2	L3	S1	S2	Weight g/1 piece	Order code*	PN (bar) ¹⁾			
										CF	A3C	71	MS
LL ²⁾	04	3.0	20	12	31	9	10	5	G04LL	100	100	100	63
	06	4.5	20	9	32	11	12	7	G06LL	100	100	100	63
	08	6.0	23	12	35	12	14	10	G08LL	100	100	100	63
	10	8.0	23	12	35	14	17	13	G10LL	100	100	100	63
	12	10.0	23	11	35	17	19	16	G12LL	100	100	100	63
L ³⁾	06	4.0	24	10	39	12	14	12	G06L	500	315	315	200
	08	6.0	25	11	40	14	17	16	G08L	500	315	315	200
	10	8.0	27	13	42	17	19	23	G10L	500	315	315	200
	12	10.0	28	14	43	19	22	28	G12L	400	315	315	200
	15	12.0	30	16	46	24	27	51	G15L	400	315	315	200
	18	15.0	31	16	48	27	32	69	G18L	400	315	315	200
	22	19.0	35	20	52	32	36	90	G22L	250	160	160	100
	28	24.0	36	21	54	41	41	137	G28L	250	160	160	100
	35	30.0	41	20	63	46	50	214	G35L	250	160	160	100
	42	36.0	43	21	66	55	60	296	G42L	250	160	160	100
	S ⁴⁾	06	4.0	30	16	45	14	17	26	G06S	800	630	630
08		5.0	32	18	47	17	19	37	G08S	800	630	630	400
10		7.0	32	17	49	19	22	44	G10S	800	630	630	400
12		8.0	34	19	51	22	24	60	G12S	630	630	630	400
14		10.0	38	22	57	24	27	77	G14S	630	630	630	400
16		12.0	38	21	57	27	30	90	G16S	630	400	400	250
20		16.0	44	23	66	32	36	143	G20S	420	400	400	250
25		20.0	50	26	74	41	46	251	G25S	420	400	400	250
30		25.0	54	27	80	46	50	330	G30S	420	400	400	250
38		32.0	61	29	90	55	60	545	G38S	420	315	315	200

¹⁾ Pressure shown = item deliverable

²⁾ LL = very light series; ³⁾ L = light series; ⁴⁾ S = heavy series

$$\frac{PN \text{ (bar)}}{10} = PN \text{ (MPa)}$$

Delivery without nut and ring. Information on ordering complete fittings see page 17.

*Please add the **suffixes** below according to the material/surface required.

Order code suffixes		
Material	Suffix surface and material	Example
Steel, zinc plated, chrome ⁶ -free	CFX	G16SCFX
Steel, zinc yellow plated	A3CX	G16SA3CX
Stainless Steel	71X	G16S71X
Brass	MSX	G16SMSX